

triton Router Mounting Plate AJA 150

FITTING YOUR ROUTER

The Alignment Disc (B) provides easy and accurate positioning of the router on the Mounting Plate (A).

First fit a straight cutter to your router. The alignment disc fits onto a $\frac{1}{2}$ " (12.7mm) shank cutter, but if you are fitting a $\frac{1}{4}$ " (6.35mm) or a $\frac{5}{16}$ " (8mm) shank cutter, use the appropriate adaptor ring (C or D), located in the sides of the disc. The adaptor ring fits into the centre of the alignment disc. It should be fitted to the cutter shank before fitting the cutter to the router.

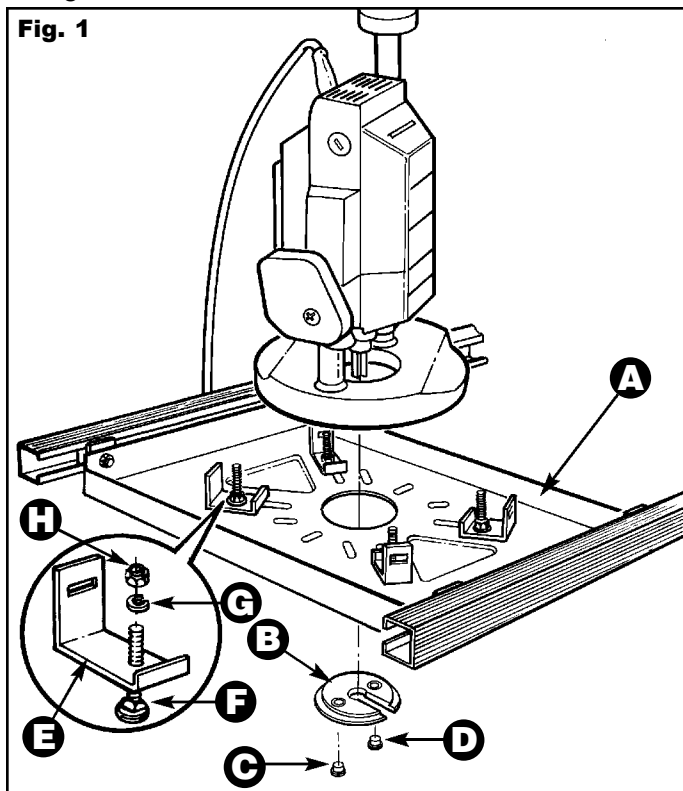

Fit the mounting plate into the bearing channels of your Workcentre.

Set your router height so that the cutter shank protrudes through the hole in the mounting plate. Push the alignment disc onto the shank of the cutter and snap it into the centred position.

Manoeuvre the router until you are able to clip the disc into the hole in the mounting plate. Your router is now exactly centred over the hole in the plate.

Fit the four Router Locators (E) to the longer slots in the plate, using the four Coach Bolts (F), Spring Washers (G) and Hex Nuts (H), as shown in Fig. 1. Note that the lower lip of each locator should fit hard up against the side of the router base. Do not fully tighten the hex nuts yet.

If your router has a round base you should now be able to rotate the router until you have four clear positions on the top edge of the base for fitting the top clamps. The handles of the router may have to overhang the edges of the plate but try to keep the overhang to a minimum.

If your router has a square or rectangular base you may need to reposition one or more of the locators until you have found four clear positions for fitting the top clamps. See "Some possible fitting problems" below.

Note that the four clamps should be spaced as equally as possible around the router base. Once the locators are correctly positioned, use a spanner to securely tighten the hex nuts. Place the Top Clamps (I) over the coach bolts and hook them into the locators. Note that the bent portions of the top clamps angle downwards.

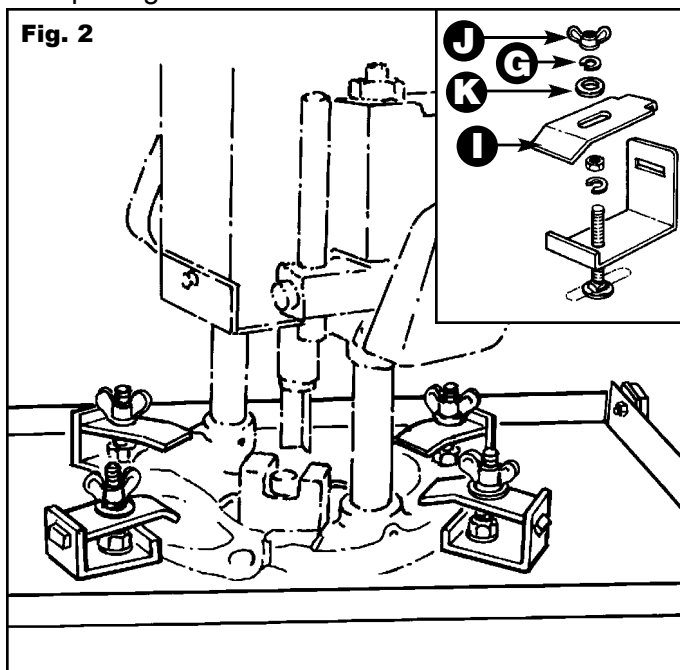

The top clamps are secured by the Wing Nuts (J), after first placing the Washers (K) and then the Spring Washers (G) onto the coach bolts, as shown in Fig. 2.

Remove the alignment disc from the cutter shank and store it for possible future use.

Some possible fitting problems

If you cannot find four clear positions for the top clamps, because of obstructions on the router base, you may need to slightly modify one or more of the clamps. Either file off a corner, or use a hacksaw to cut away part of the clamp so that it clears the obstruction.

In rare cases where it is still impossible to fit all four clamps, even with modifications, you may need to re-locate one or more of the clamps. Sometimes the jigsaw mounting slots can be used. Alternatively, drill a new hole or holes (7mm or $\frac{9}{32}$ " in the mounting plate.

If your router has a large D-handle (eg. Makita 3601B), angle the handle diagonally across the mounting plate.

Overhead Routing

Insert the mounting plate into the bearing channels of your Workcentre and spray some lubricant (RP7, WD40 or similar) into the channels to ensure a smooth slide. The main table of the Workcentre is used to support material when overhead routing.

The router cutter will probably not reach the workpiece even at full cutter depth. Do not raise the table. Rather, use flat packing (18mm particle board or similar) to raise the workpiece.

If you ever do raise the table, make sure you lower it again when refitting your saw, or you may accidentally cut into the subframe bars under the blade slot.

Cross Trenching

When working with long, wide or heavy pieces, such as shelving, cupboard sides etc., cross trench as shown below in **Fig. 3**.

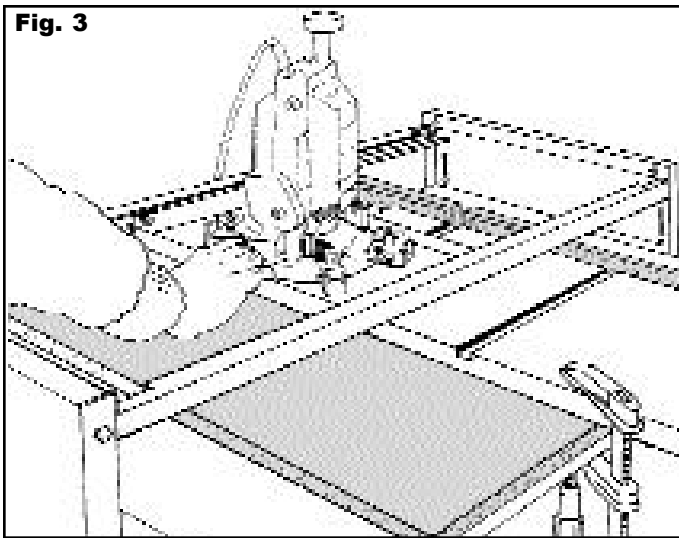

Use the on/off switch on the Workcentre rather than the switch on the router itself, and push the mounting plate rather than the router. The cutter will exert strong sideways thrust on the workpiece. Preferably clamp it in position as shown.

Always do a "dummy run" after each new set-up. Remove the workpiece, keep the power switched off and make sure the cutter won't hit anything as you slide the mounting plate from end to end.

Make deep trenches by making two or three shallow passes rather than one deep pass. This results in more accurate trenches and a smoother finish, and your router cutters will stay sharp longer.

Angled Trenching

If angle trenching (for louvres, steps, etc.) remove the workstops or crosscut fence and clamp a straight wooden guide across the table at the desired angle. When possible clamp the workpiece to the table.

Stopped Trenches

Clamp a piece of scrap wood to the bearing channel to act as a stop block for "blind" or "stopped" trenches.

FITTING YOUR JIGSAW

To fit your jigsaw to the mounting plate use the Coach Bolts (**F**), and only use the top clamps (**I**), as shown in **Fig. 4**. Use the washers (**K**), Spring Washers (**G**) and Wing Nuts (**J**) as illustrated.

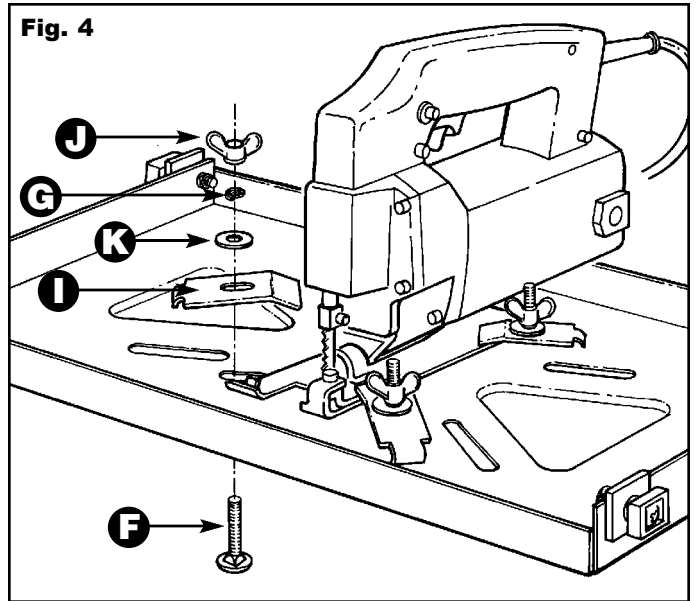

The jigsaw blade should be positioned centrally in its small slot in the mounting plate.

If the size or shape of your jigsaw base is unusual, you may need to relocate one or more of the clamps by drilling the mounting plate. Alternatively, you may prefer to drill holes in the base of your jigsaw and bolt it directly to the plate.

Only use the jigsaw upside down in conjunction with the Triton Router & Jigsaw Table.

Due to our company policy of continuous product improvement, specifications may change without prior notice.

Made in Australia by: Triton Manufacturing & Design Co. Pty. Ltd. ABN 43 000 195 951
14-18 Mills St, Cheltenham, Vic. 3192 Ph: (03) 9584 6977 Fax: (03) 9584 5510
E-mail: tools@triton.net.au Web Site: <http://triton.net.au>

International Offices:

Canada - Toll Free: 1 888 874 8661
Japan - Free Call: 0120 171 079
New Zealand - Ph: (09) 262 3052

South Africa - Free Call: 0800 600 432
United Kingdom - Free Call: 0800 856 7600
USA - Toll Free: 1 888 874 8661

A **Hills** Company