

triton Multi-Stand



Assembly & Operating Instructions

Components List

Main Body Assembly	1	A
Head Assembly	1	L
Front Quadrant	1	C
Rear Quadrant	1	D

Fasteners Bag

Saddles	4	B
Pan Head Bolt (M6 x 10)	4	M
Hex Bolt (M6 x 80mm)	1	J
Round Knob & M6 Nut	1	K
Small Washer	2	F
Hex Bolt (M6 x 60mm)	1	E
Nyloc Nut (M6)	1	G
Large Washer	1	H
Quadrant Washer	1	I

Assembly

Fold the legs of the Main Body Assembly (**A**) fully outwards. Loosen the round knob and extend the stem upwards, then tighten.

Note: The legs should pivot firmly. Adjust the nuts on the leg pivot bolts if necessary.

Fit the Saddles (**B**) to the stem using the locating pins on the saddles as shown.

Attach the Front (**C**) and Rear (**D**) Quadrants using the shorter Hex Bolt (**E**), Small Washers (**F**) and Nyloc Nut (**G**). Do not over-tighten.

Fit the Quadrant Washer (**I**) onto the longer Hex Bolt (**J**) with the hex head located in the tabs on the washer. Insert the bolt through the slots in the quadrants, **ensuring that it passes through the washer held within each quadrant** and the hole in the lower stem saddles. Fasten the Large Washer (**H**) onto the bolt with the Round Knob (**K**).

Rotate the quadrants until the flat tops are horizontal then gently nip up the round knob.

Fasten the Head Assembly (**L**) to the quadrants using the Pan Head Bolts (**M**). The round knob on the clamp which is built into the head should be on the same side as the round knob on the quadrant.

Adjust the nut tension on the pivot bolt (**E**) if necessary. The head should pivot firmly, and should lock tightly at any selected angle when the quadrant knob is tightened.



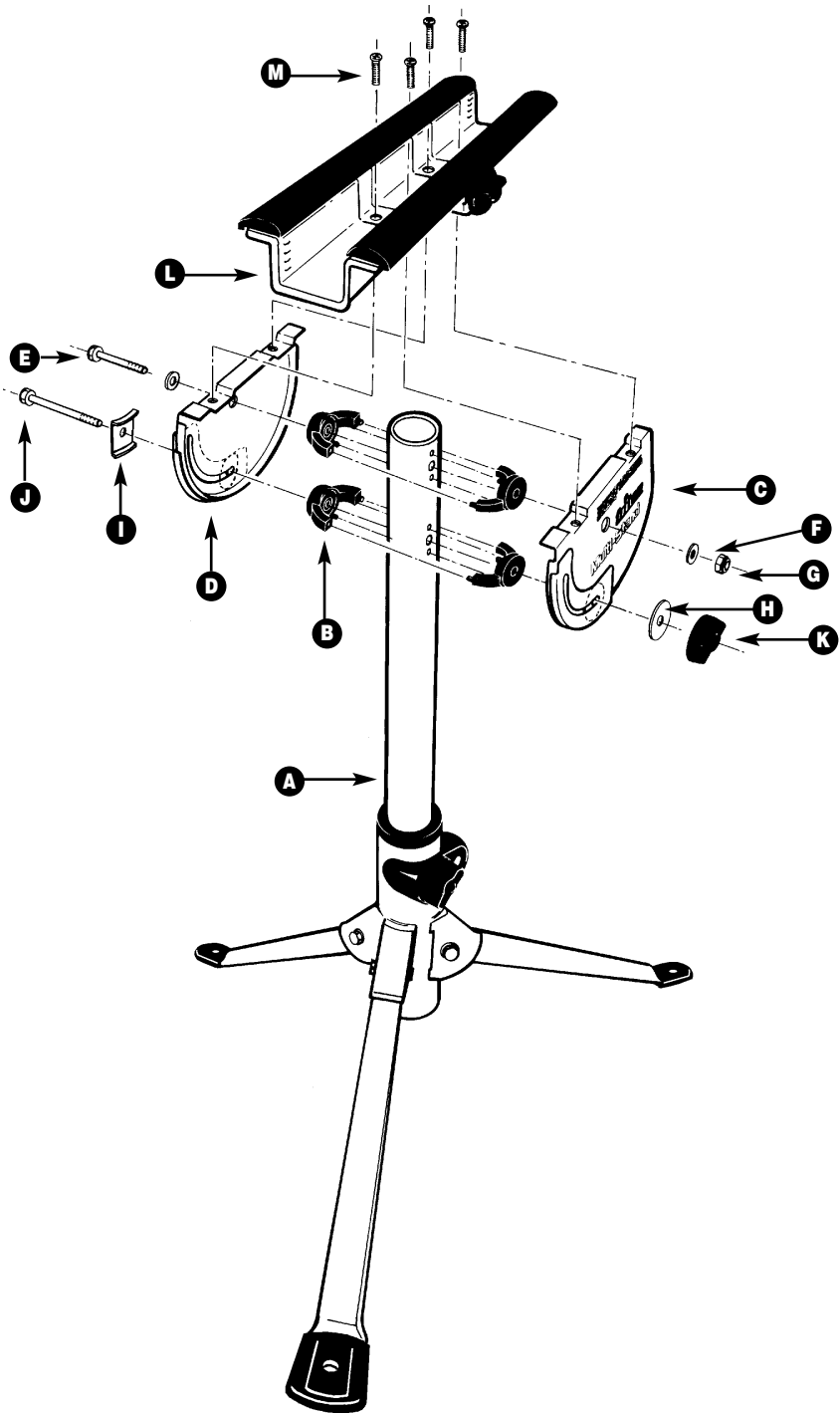

Notes on Use

- **Make sure the legs are fully opened**, and that both the stem clamp and the quadrant clamp are fully tightened before applying heavy loads.
- **Do not overload.** Max. load per Multi-Stand 100kg (220lb).
- **Do not stand on this product.**
- When using the head clamp to clamp materials less than 30mm, use a packing piece.



- Clamp an extension piece (ie. an offcut of sheet material - as shown on product carton) into the head channel if using Multi-Stand to support material at a height greater than its maximum adjustment.



- When clamping easily damaged materials, eg. doors, use thin packing on both sides to avoid damage.



- Make sure the Multi-Stand is securely pegged down to the ground when applying non-vertical loads; or when on steeply sloping ground.